

Facilities – Hillsboro Campus

The **Library-Administration Building**, The original 1966 two-story Library Building reopened in March 2018 after a complete renovation. The new Library space has a collection of over 75,000 items, 75 student PCS, individual and group study spaces, abundant natural and LED lighting, expert



assistance with research, and houses the **Center for Teaching and Learning**. The main entrances for the Library are on the northeast and west sides of the building. The entrance to the renovated and expanded is located on the southeast side of the Library Building. The Administration side has offices for the President, Institutional Advancement, Public Relations and Marketing, Human Resources, and the Business Office.

The sprawling **Career & Technical Education Building** contains 75,246 square feet of classrooms, offices, and laboratories, as well as Adult Education and Literary services. Equipment representing the latest advancements in technology is available to students.



The **Field House** complex provides facilities for physical education and intercollegiate sports, including an indoor pool. The building is also used for cultural and social programs throughout the year.

Music, theatre, and art find their home in the **Fine Arts Building**. The building offers classrooms, practice space for the music department, art studios, dedicated computer labs, and a gallery for displays by residents and visiting artists. The Fine Arts Theatre hosts concerts, plays, meetings, and festivals for both Jefferson College and for the community.



The **Technology Center**, a 43,000 square foot, three-level structure featuring a center atrium design, houses state-of-the-art facilities, the Academic Success Center, Disability Support Services, and equipment for several high-tech programs.

The majority of liberal arts classes are held in the **Arts and Sciences I Building**. Comfortable, well-lighted classrooms and fully-equipped science and language laboratories are located there as well as a student lounge. Lecture halls accommodate larger groups, and the intimate Little Theatre is often used for studio theatre productions, musical programs, films, and lectures.



Arts and Sciences II includes a computer laboratory, JCTV studios, general purpose classrooms, faculty offices, and a student lounge.

When students attend classes, their second home is the **Student Center**.

From registration to Commencement, Student Services provides educational information and guidance on everything from financial aid to career choices. The main floor is the “one stop shop” for student needs and the Missouri Baptist University transfer office. The Cafeteria provides great food and refreshments, a giant screen TV, wireless Internet, and plenty of room for socializing. The Cafeteria is located on Level I with the Viking Room and the College **Bookstore**. This floor also houses the Vikings’ Vault food pantry for students. The top floor of the building is occupied by Student Development and Project SUCCESS. Student Senate also has an office on the top floor.



Many of the high school students enrolled in the **Area Technical School** at the College attend classes in the Area Technical School Building. The Area Technical School Building, completed in the summer of 1999, consists of 32,709 square feet

on two levels and includes classrooms, laboratories, and offices for several technical programs available to area high school students enrolled through 11 public high schools in Jefferson College’s service area.

Hillsboro Campus Map

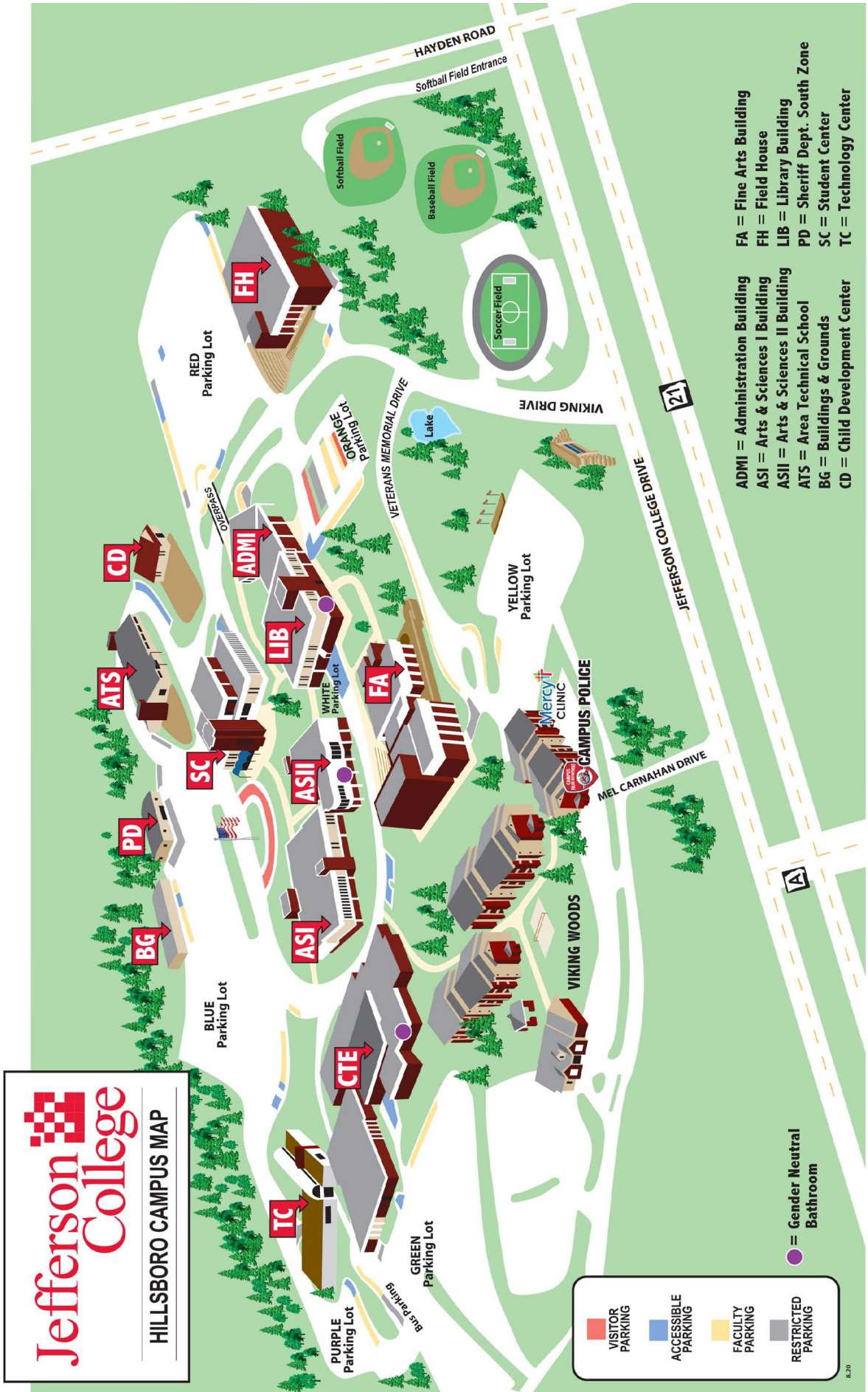

Jefferson College

HILLSBORO CAMPUS MAP

- VISITOR PARKING
- ACCESSIBLE PARKING
- FACULTY PARKING
- RESTRICTED PARKING
- = Gender Neutral Bathroom

- ADMI = Administration Building
- ASII = Arts & Sciences II Building
- ATS = Area Technical School
- BG = Buildings & Grounds
- CD = Child Development Center
- FA = Fine Arts Building
- FH = Field House
- LIB = Library Building
- PD = Sheriff Dept. South Zone
- SC = Student Center
- TC = Technology Center

Storm Safe Area Shaded

● = Fire Extinguisher

First Floor

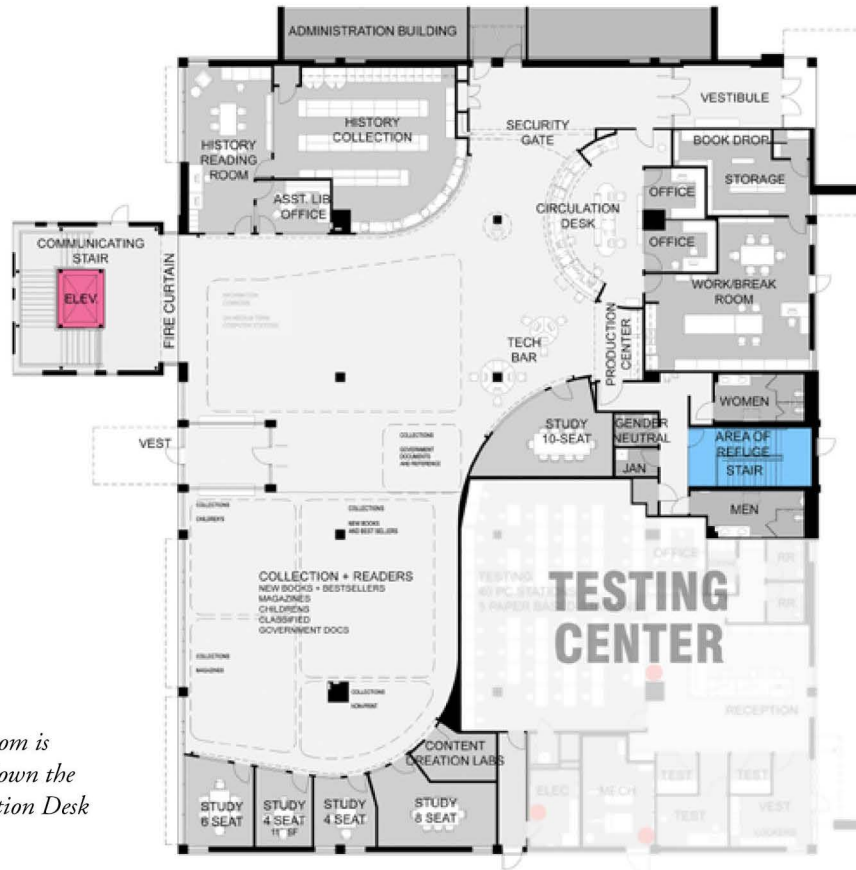

Note: Gender-neutral restroom is located on the first floor – down the hallway next to the Circulation Desk

Second Floor

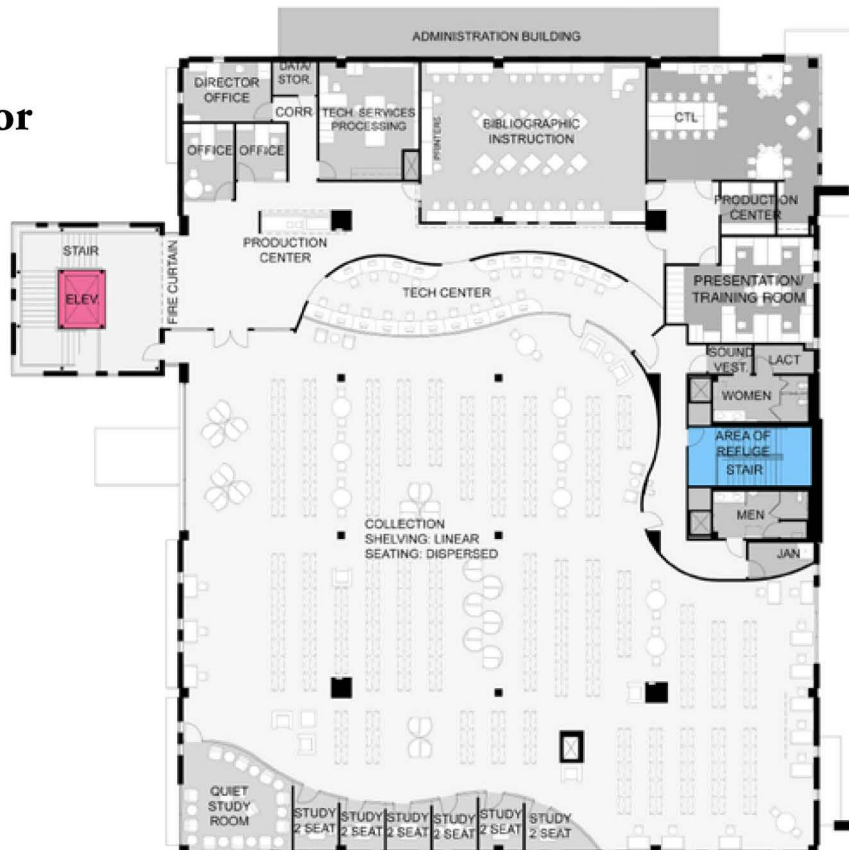

Storm Safe Area Shaded

● = Fire Extinguisher

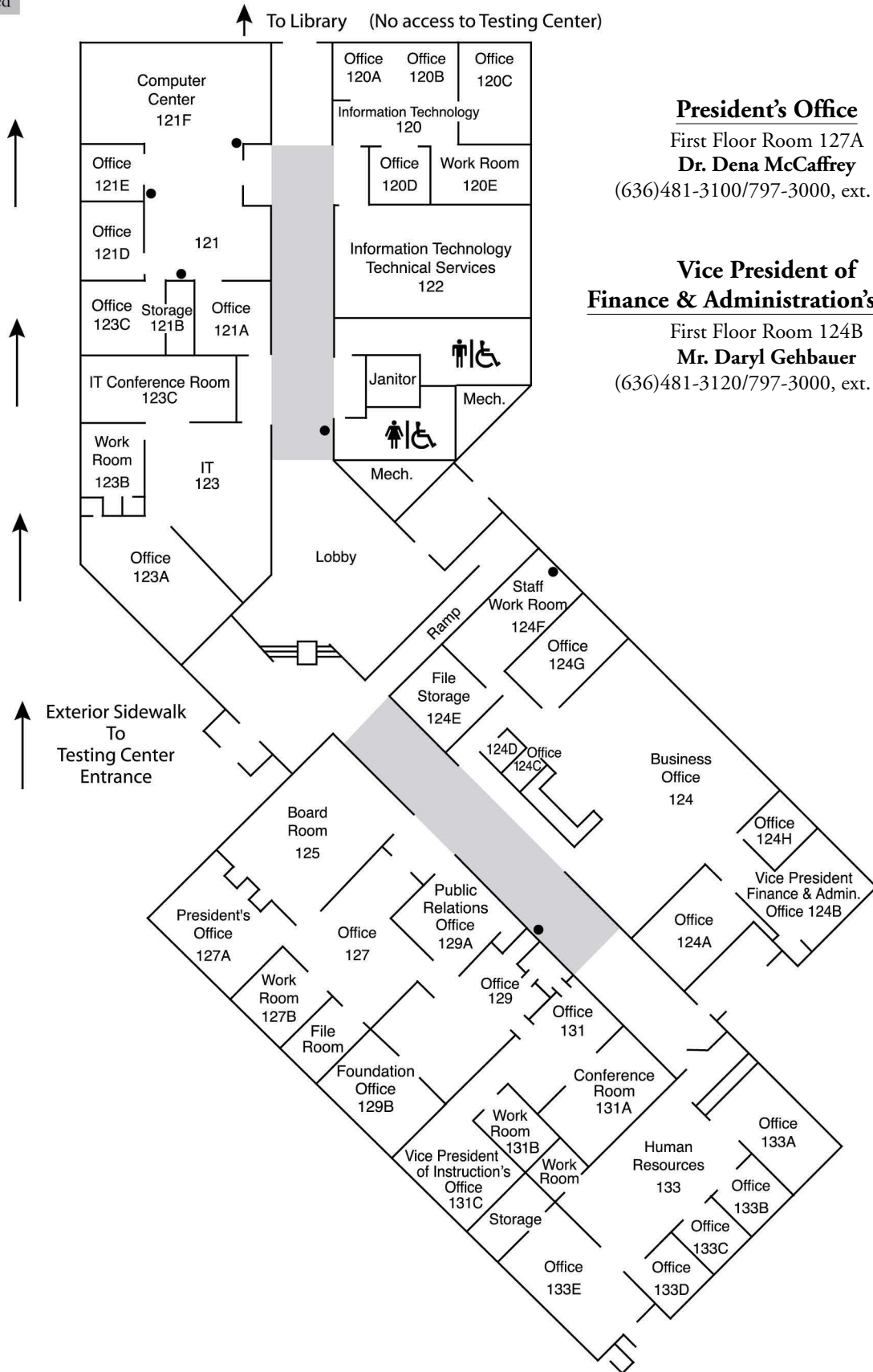

President's Office
 First Floor Room 127A
Dr. Dena McCaffrey
 (636)481-3100/797-3000, ext. 3100

Vice President of Finance & Administration's Office
 First Floor Room 124B
Mr. Daryl Gehbauer
 (636)481-3120/797-3000, ext. 3120

Storm Safe Area Shaded

● = Fire Extinguisher

First Floor

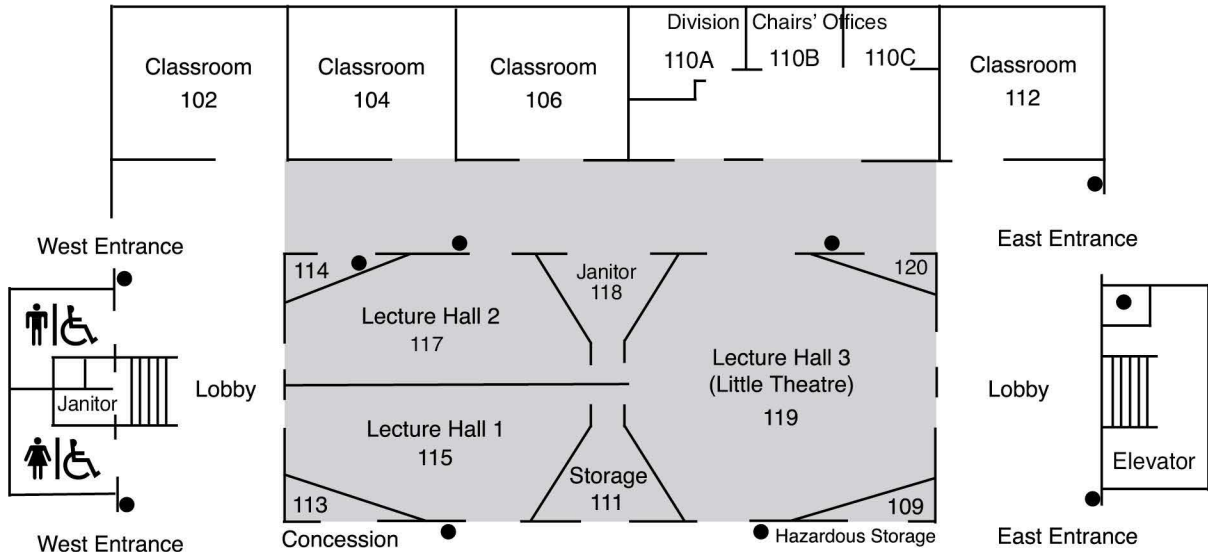

Associate Deans' Offices

Dr. Michael Booker
 School of Humanities
 636)481-3312/
 797-3000, ext. 3312

Dr. Terry Kite
 School of Business,
 Social Sciences and
 Public Services
 (636)481-3348/
 797-3000, ext. 3348

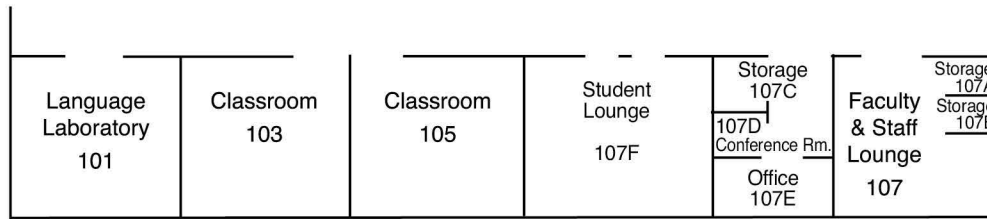

Second Floor

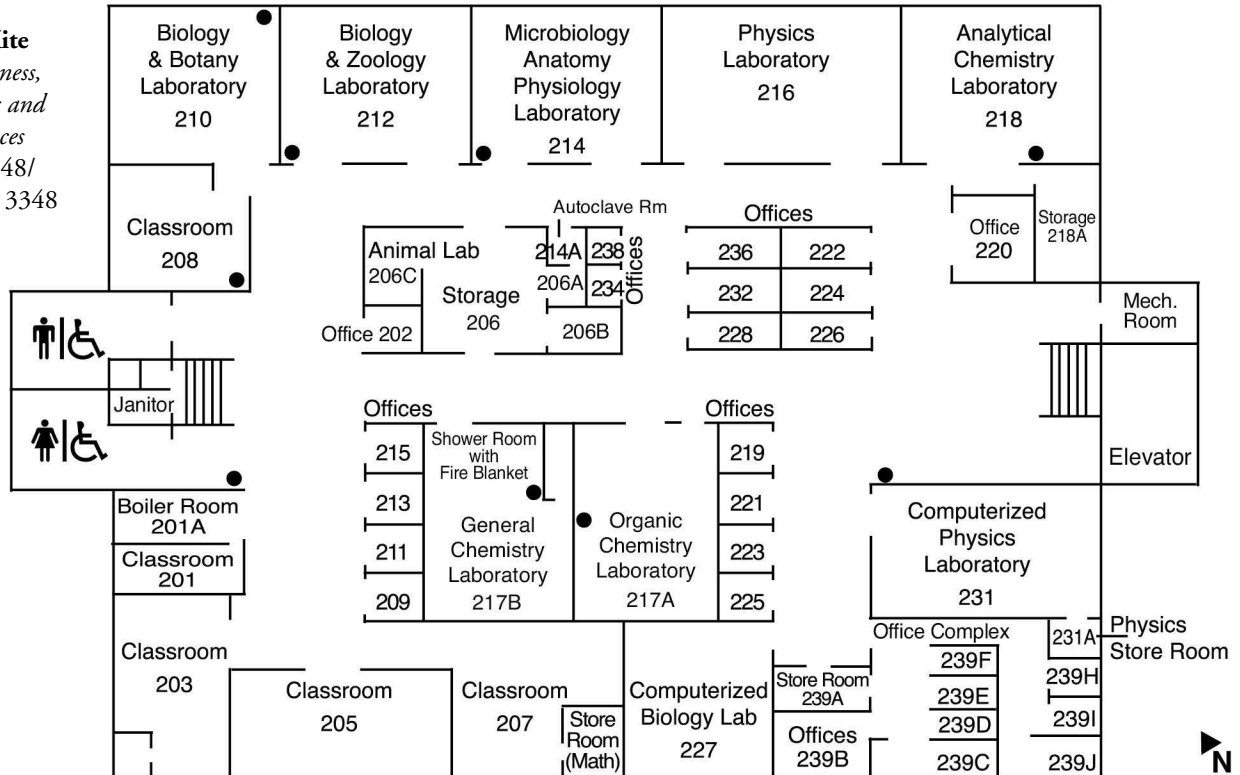

Storm Safe Area Shaded

● = Fire Extinguisher

Note: Gender-neutral restroom is located on the first floor – next to the Instructional Support Center located in Room 303

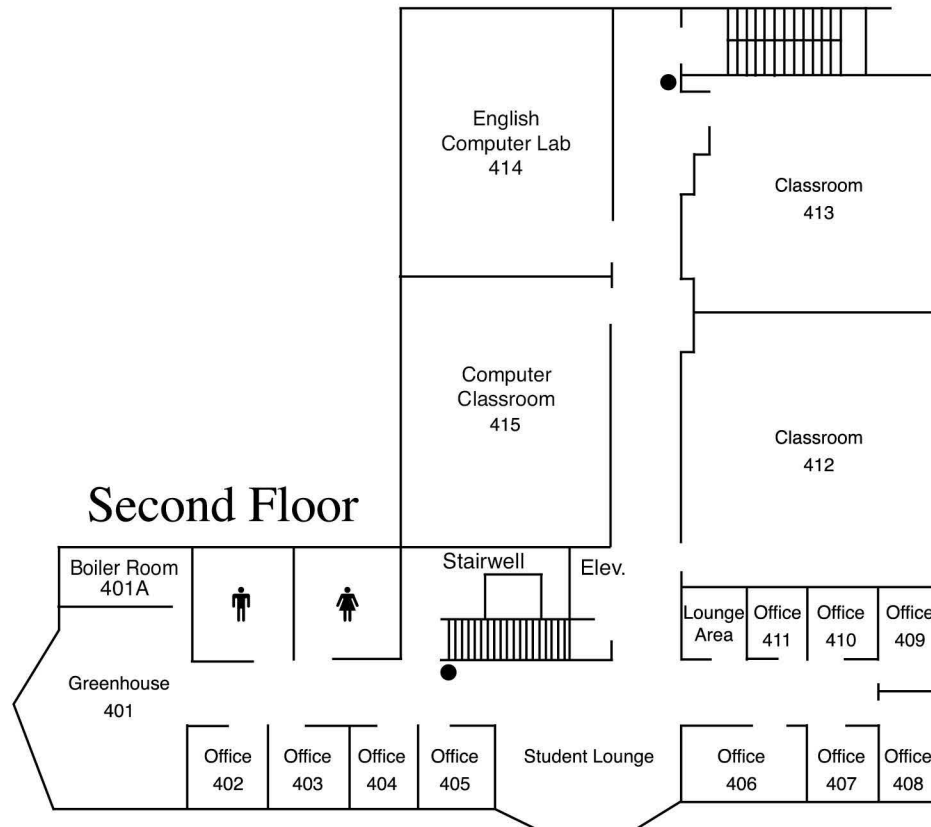
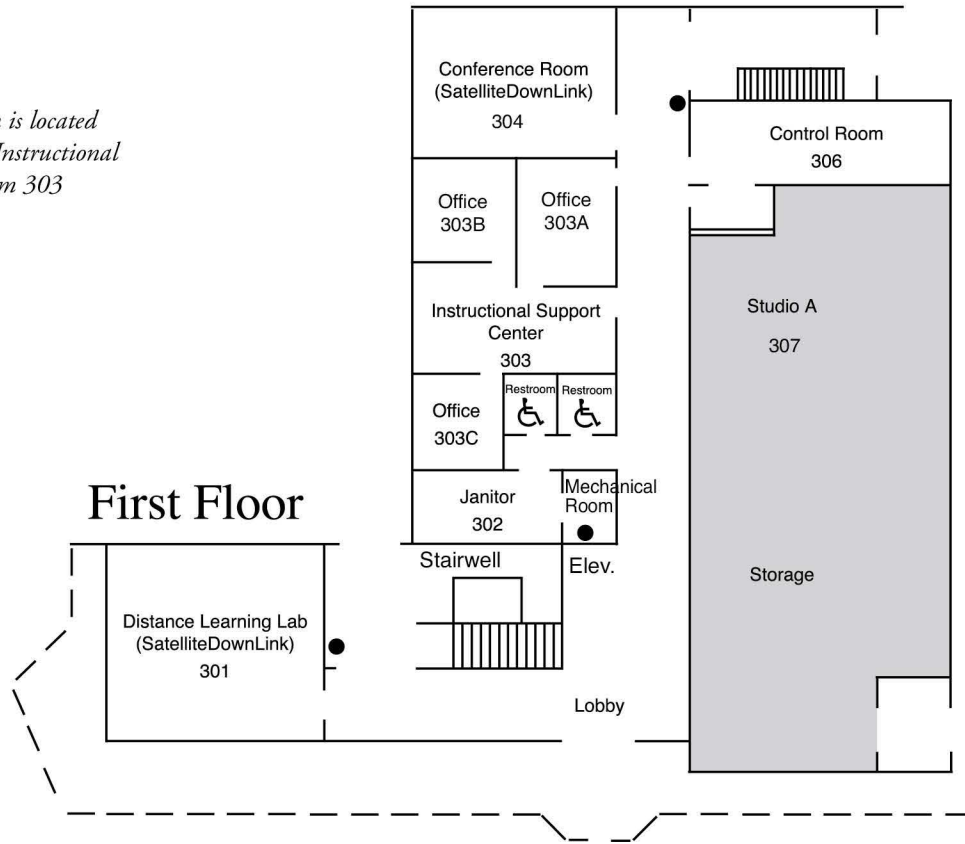

Storm Safe Area Shaded

● = Fire Extinguisher

Second Floor

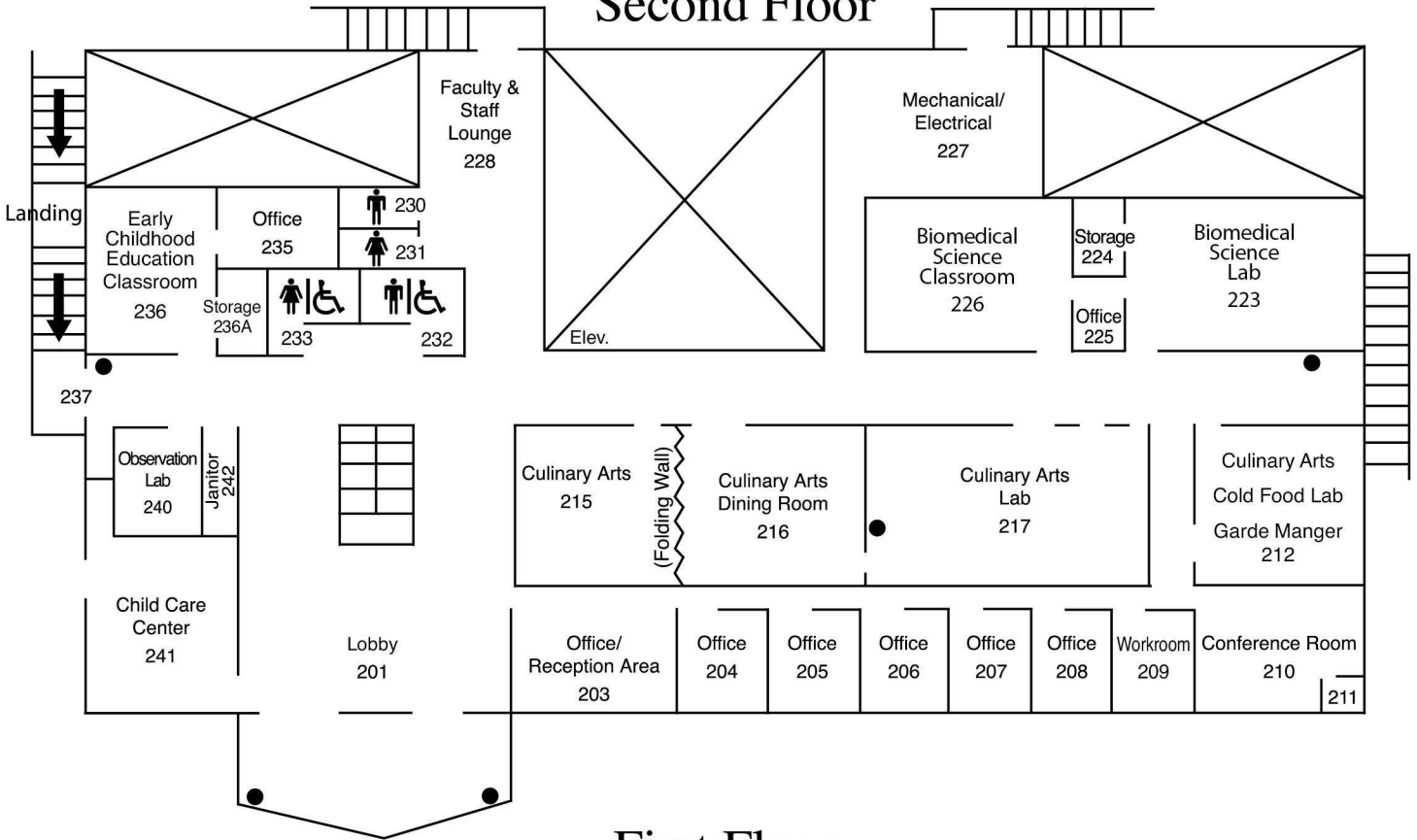

First Floor

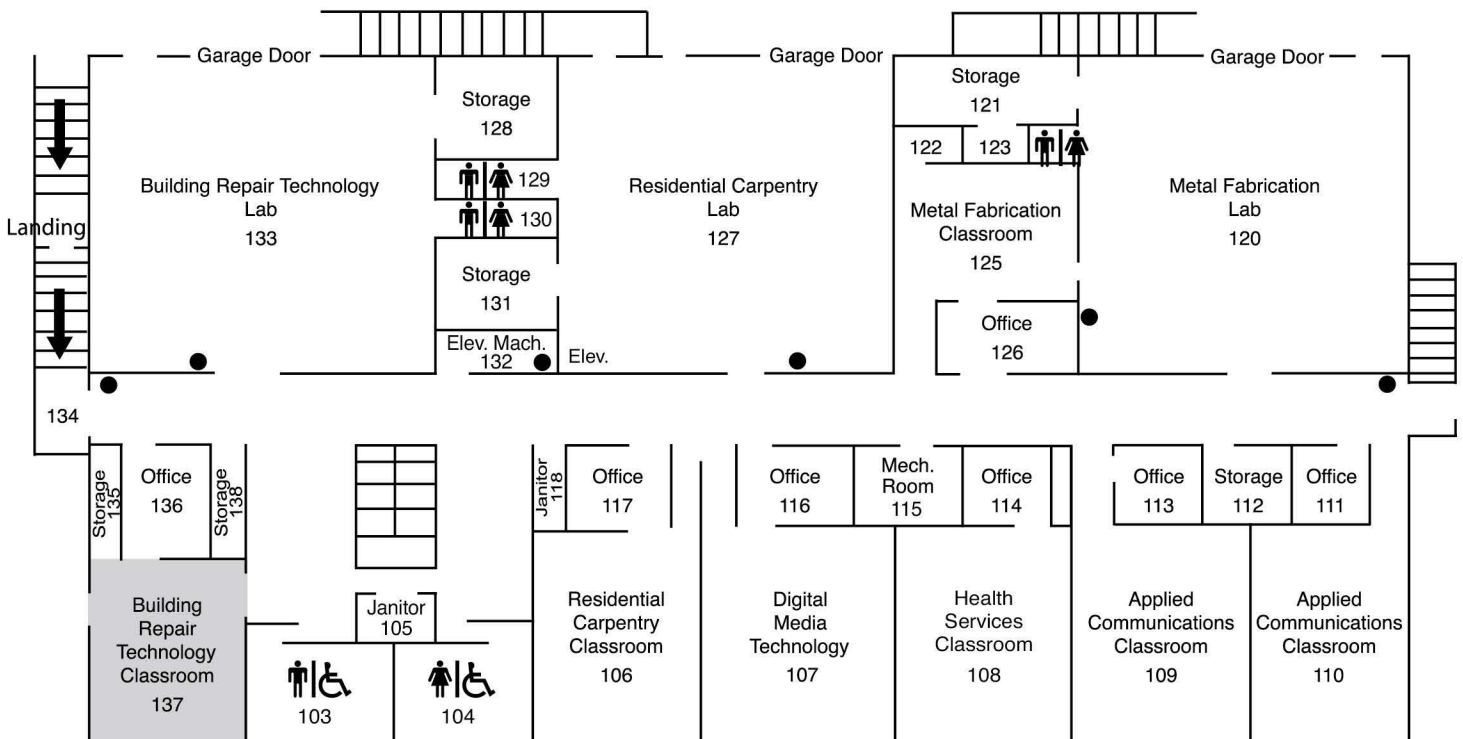

Storm Safe Area Shaded

● = Fire Extinguisher

Note: Gender-neutral restroom is located on the main level – next to the Adult Education Literacy (AEL) area located in Room 174

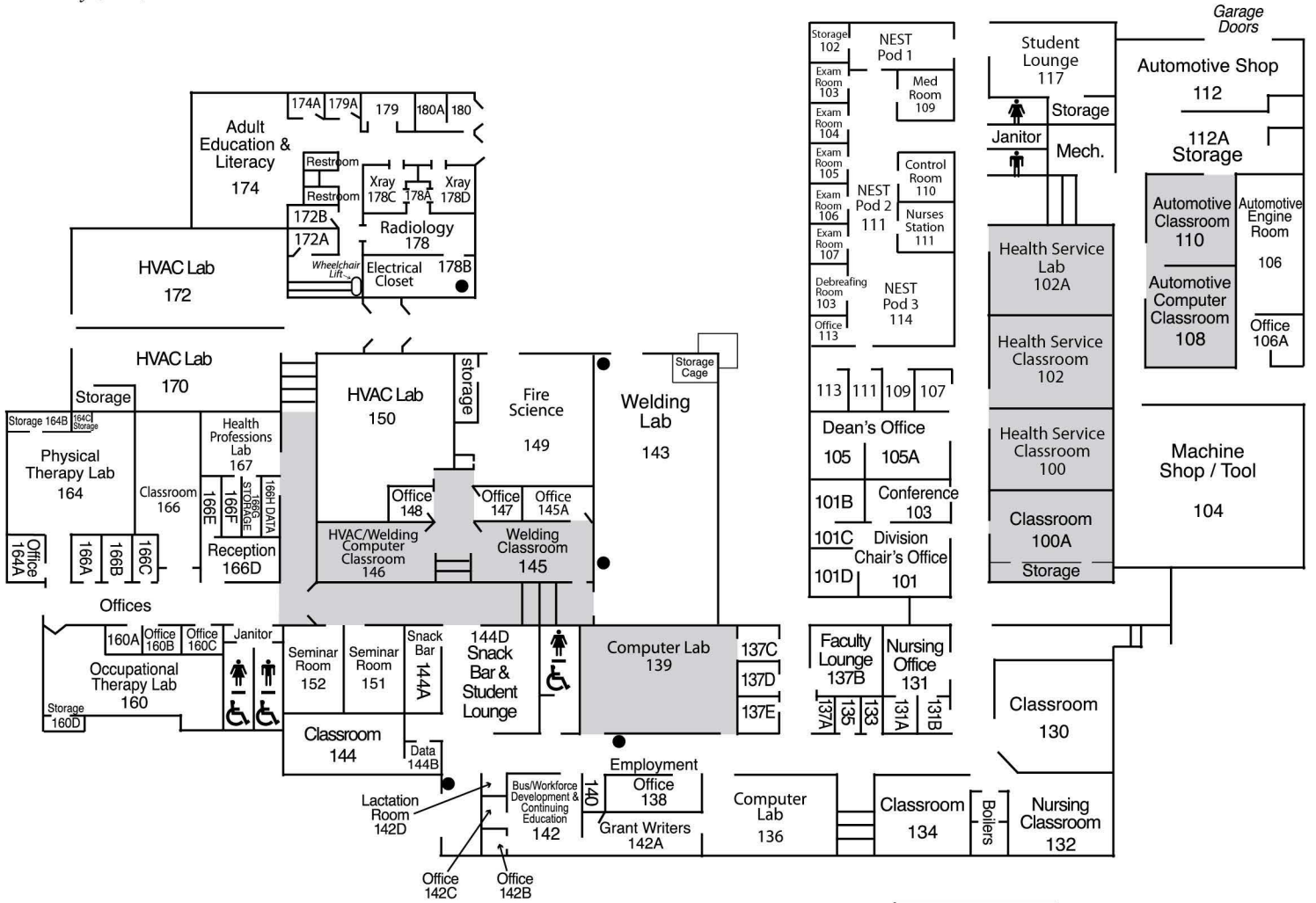

Lower Level

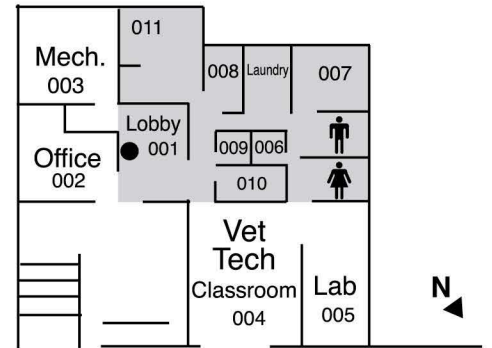

Associate Dean's Office

First Floor Room 101

Mr. Kenneth Wilson

School of Science and Health

(636)481-3356/797-3000, ext. 3356

Storm Safe Area Shaded

● = Fire Extinguisher

Main Floor

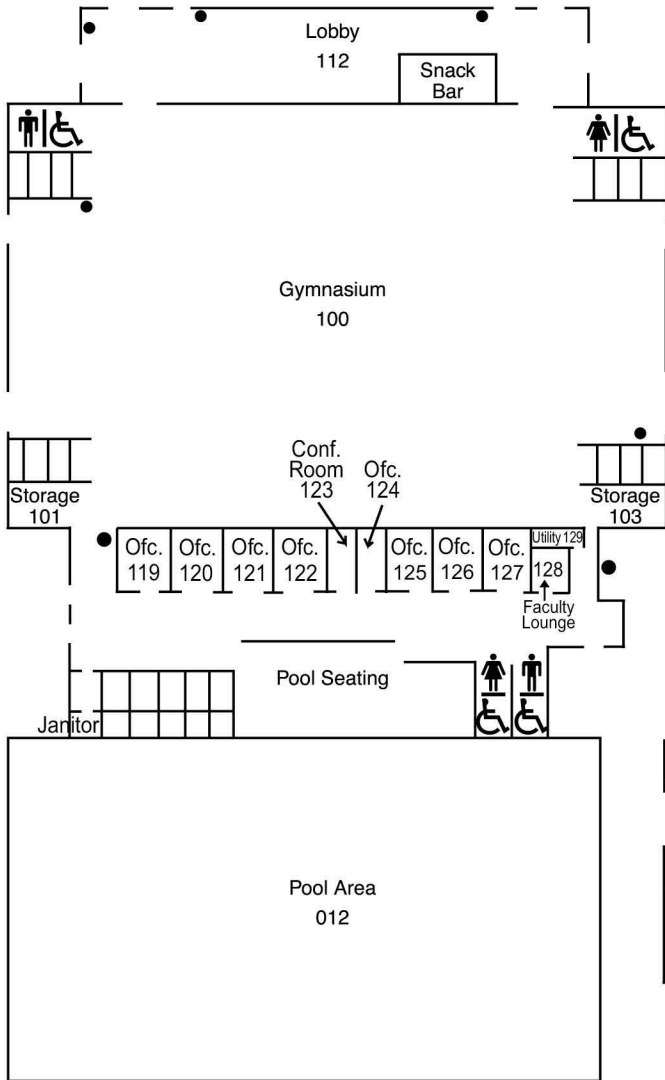

Balcony Level

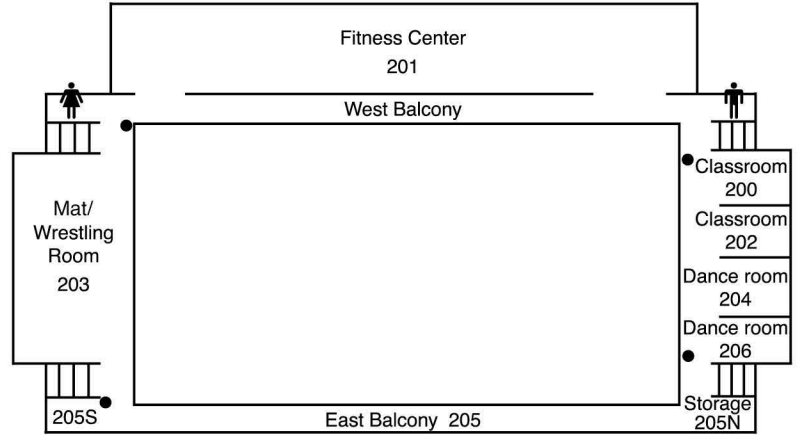

Lower Level

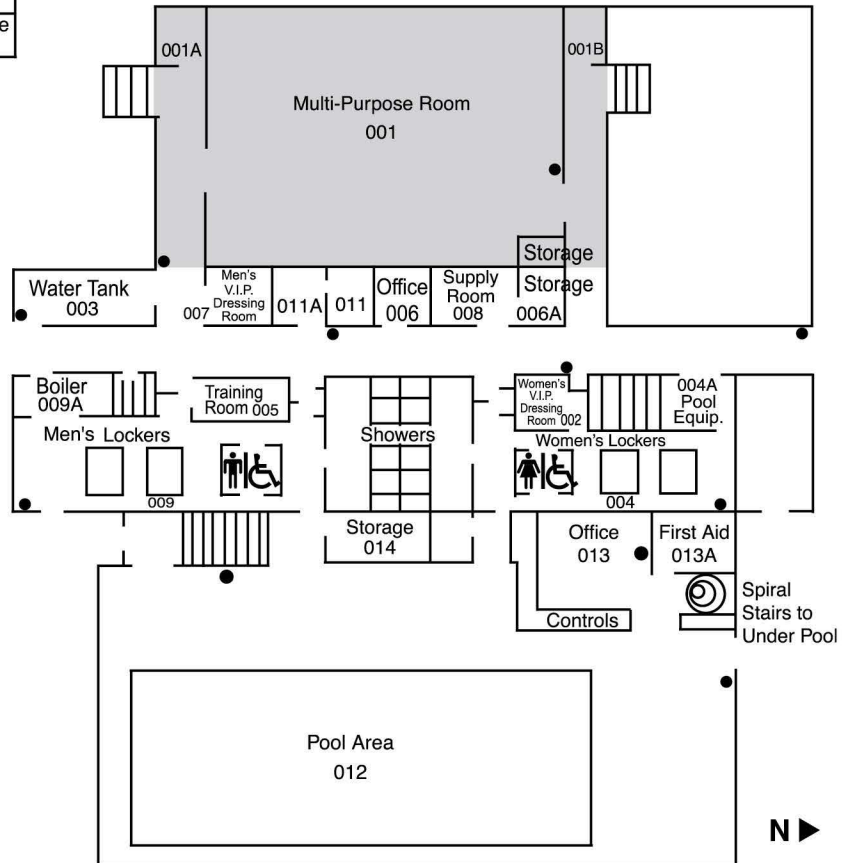

Storm Safe Area Shaded

● = Fire Extinguisher

Lower Level

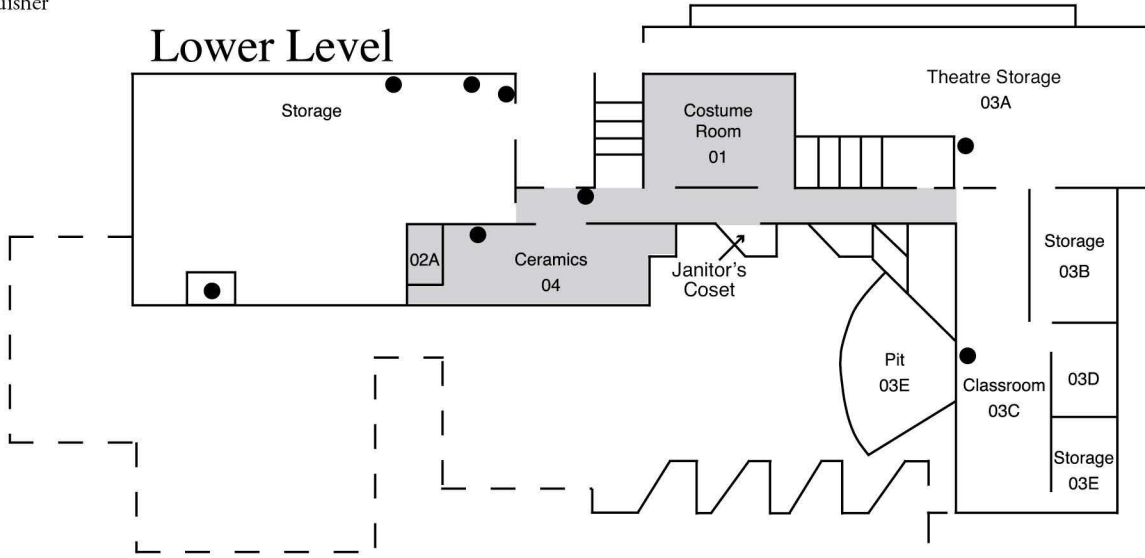

First Floor

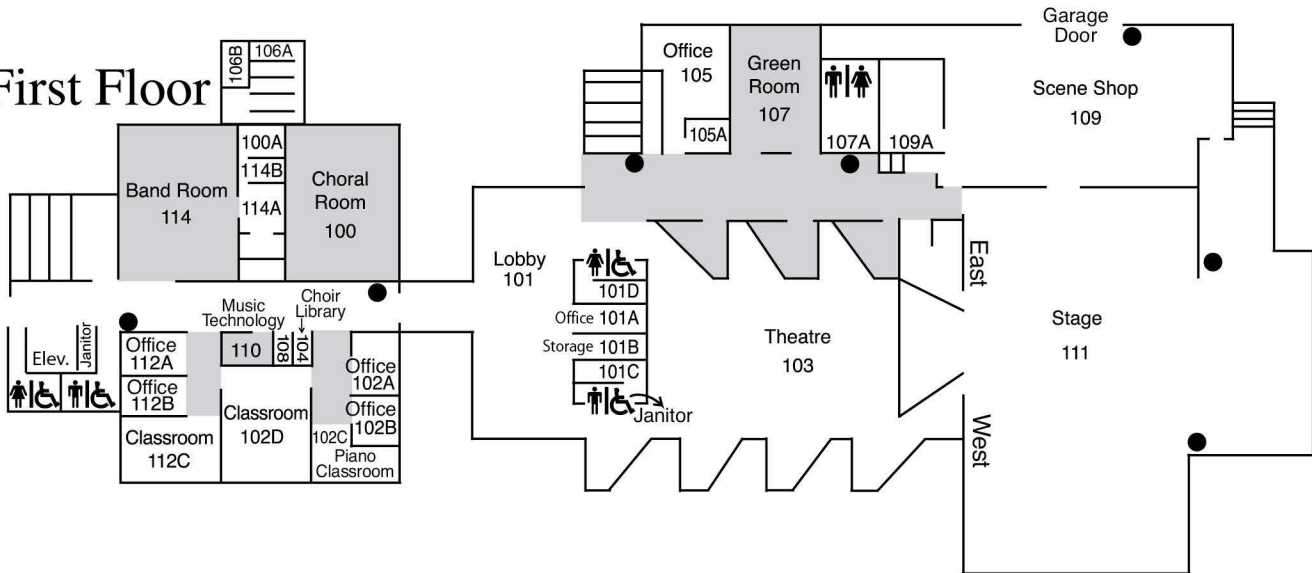

Second Floor

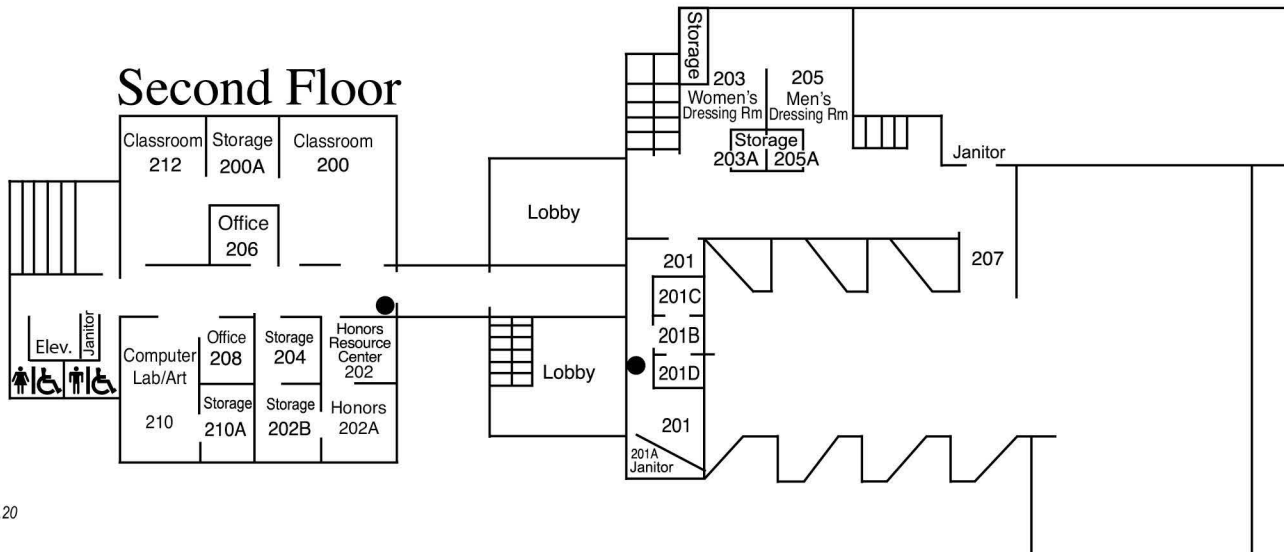

Storm Safe Area Shaded

● = Fire Extinguisher

Lower Level

Vice President's Office

Second Floor Room 205A

Dr. Kimberly Harvey-Manus

Vice President of Student Services

(636)481-3200/797-3000, ext. 3200

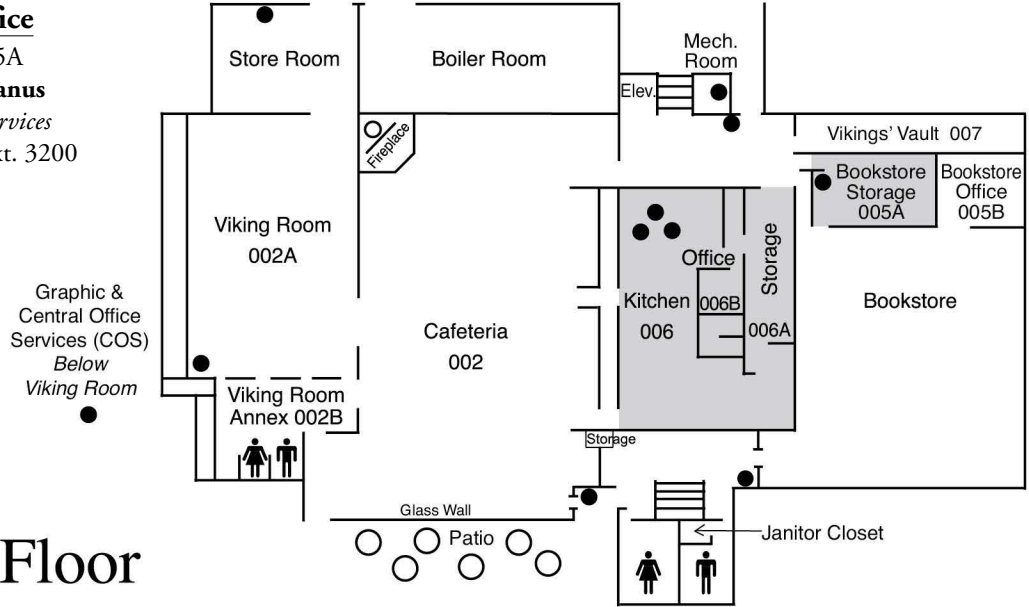

First Floor

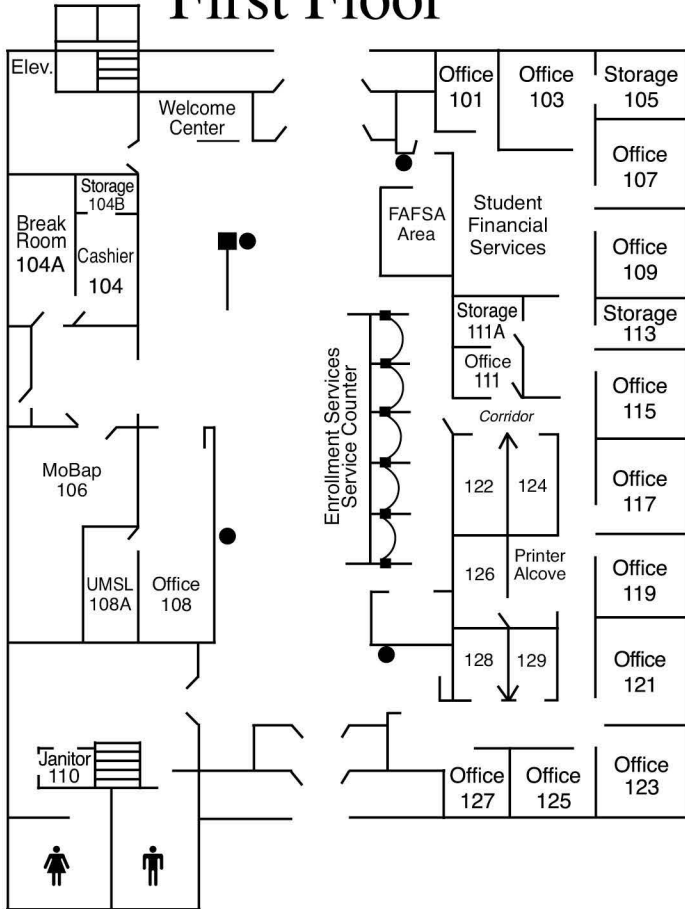

Second Floor

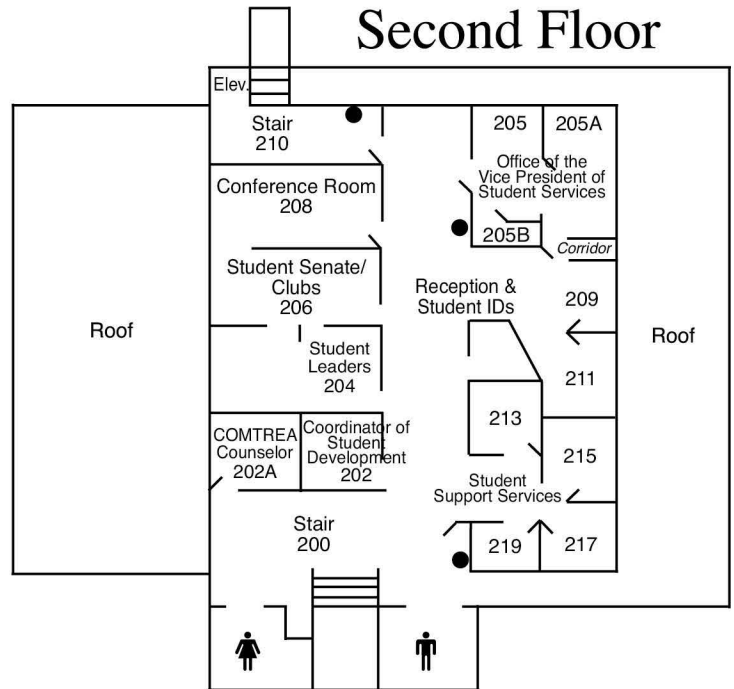

Storm Safe Area Shaded

● = Fire Extinguisher

First Floor

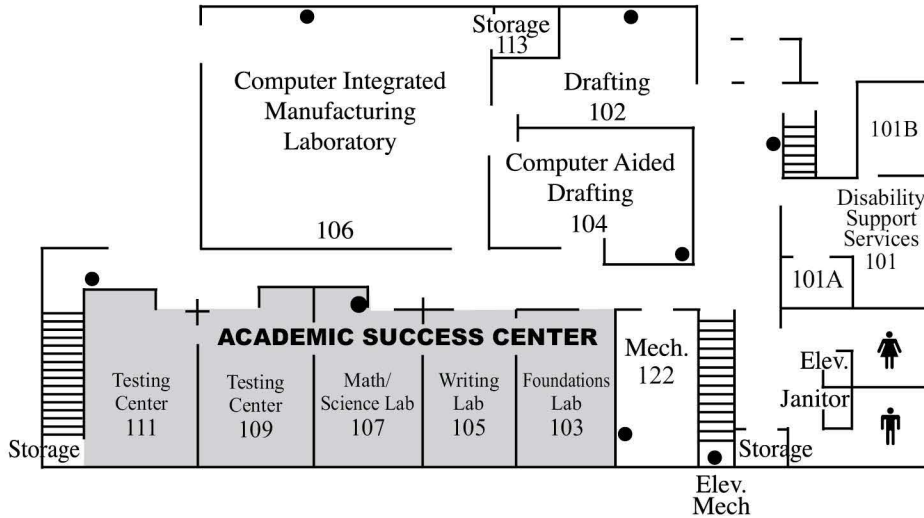

Dean of Instruction's Office

Second Floor Room 203

Dr. Christopher DeGeare

(636)481-3144/797-3000, ext. 3144

Associate Dean of Math, Science and Technology

Second Floor Room 203A

Ms. Maryanne Anglionto

(636)481-3318/797-3000, ext. 3318

Second Floor

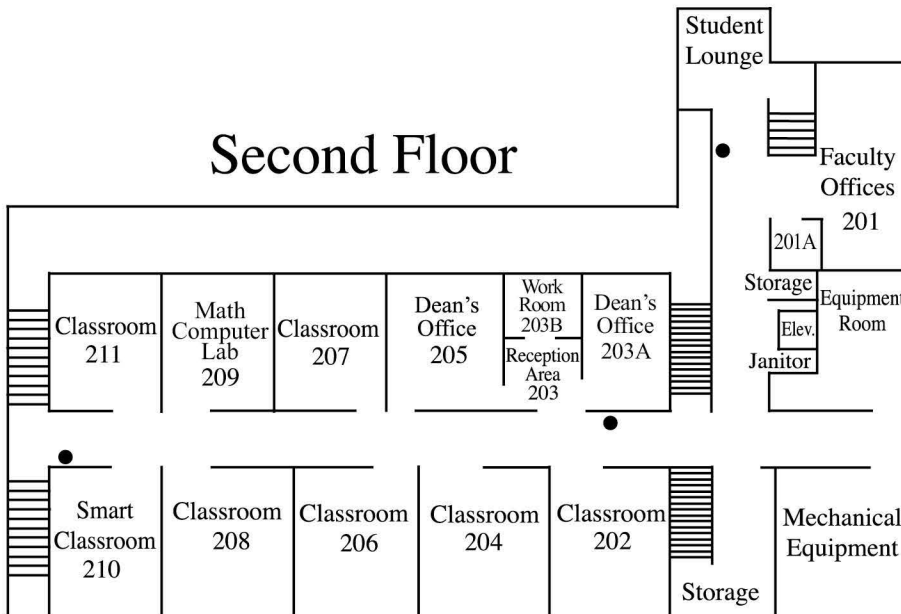

Third Floor

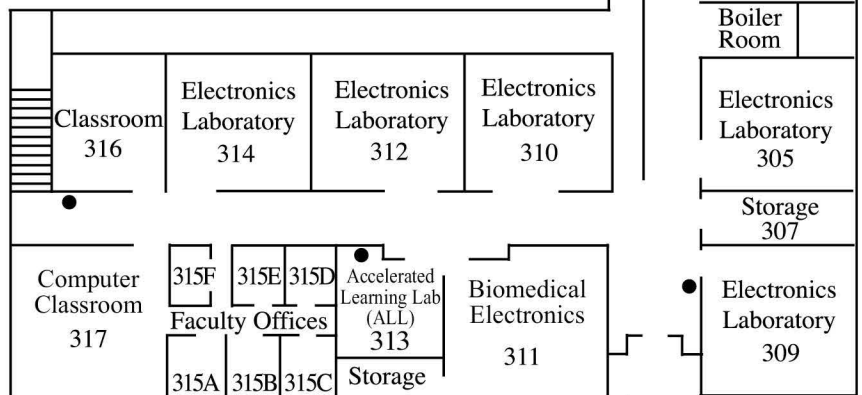

Storm Safe Area Shaded

● = Fire Extinguisher

First Floor

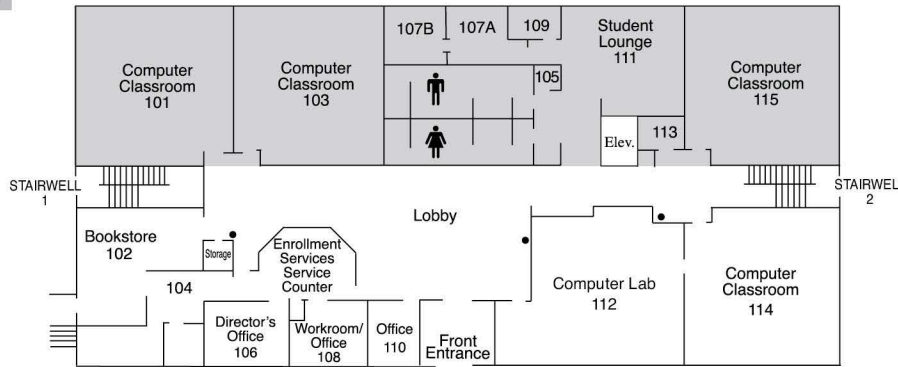

Jefferson College Arnold is located at the intersection of Highway 141 and Astra Way.

For more information, call (636)481-3597/797-3000, ext. 3597.

Second Floor

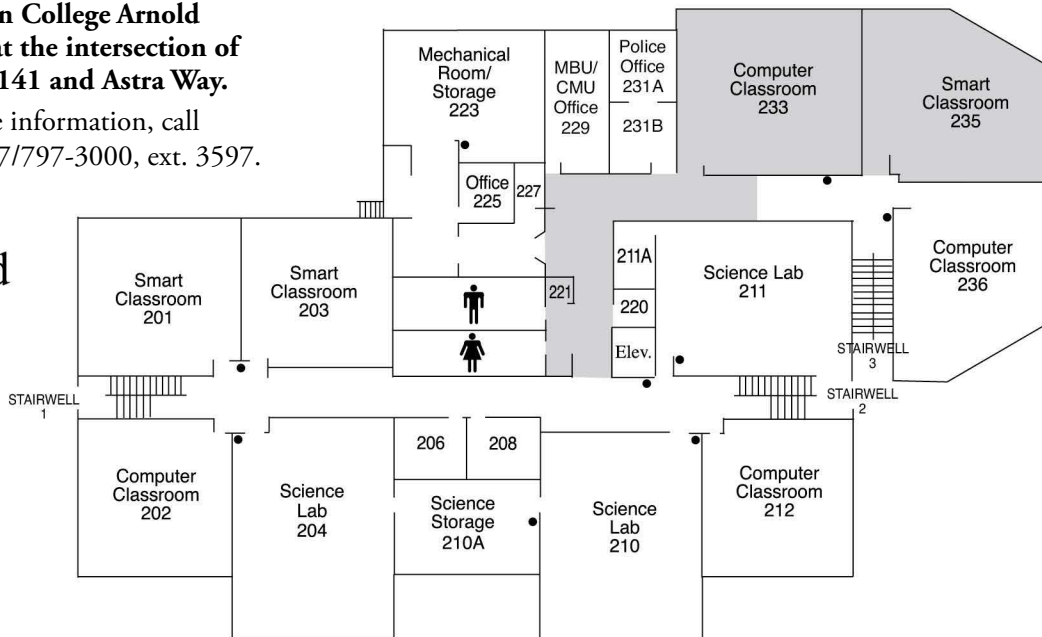

Third Floor

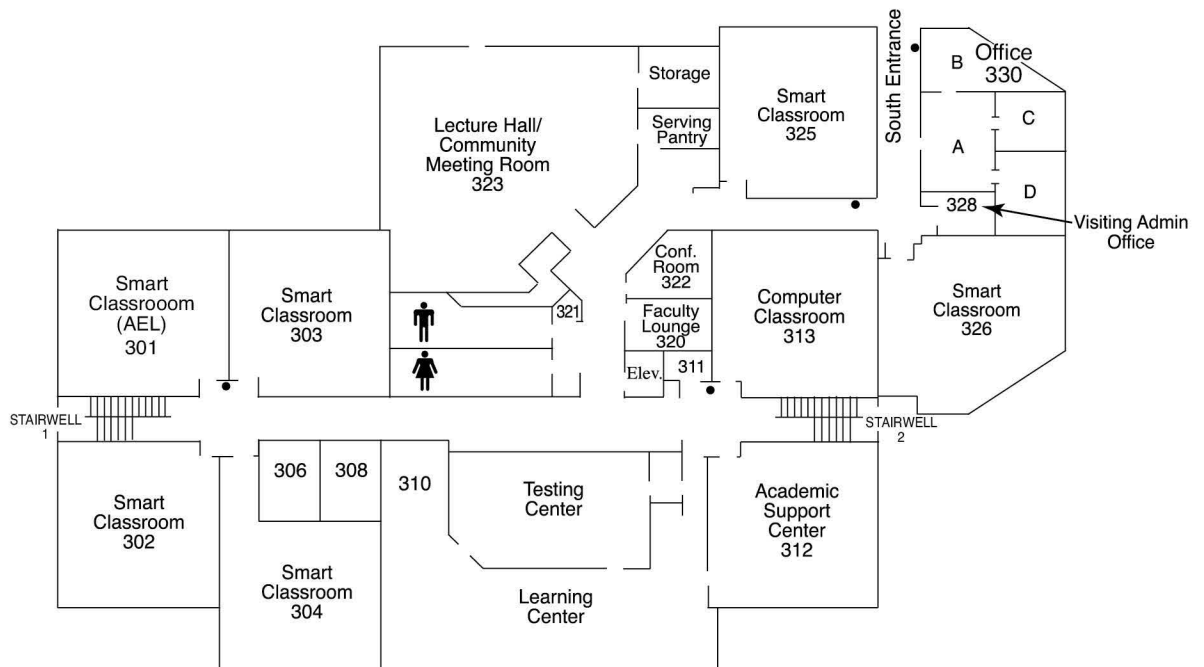

Storm Safe Area Shaded

● = Fire Extinguisher

Jefferson College Imperial is located at 4400 Jeffco Blvd. near Imperial, MO, approximately 5 miles south of St. Louis County.

For more information, call (636)481-3481/797-3000, ext. 3481.

Lower Level

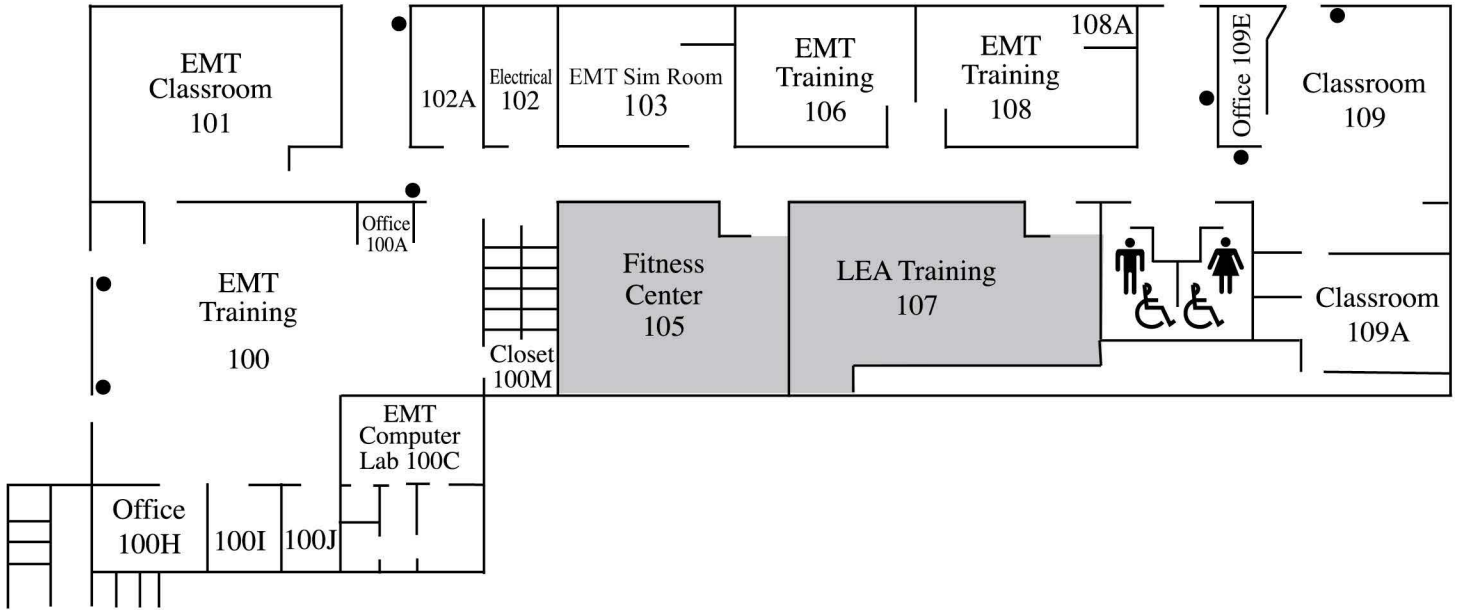

Upper Level

